

# MODEL NO. 16

## K-32 MASTERPIECE

### K FRAME .32 CALIBER REVOLVER

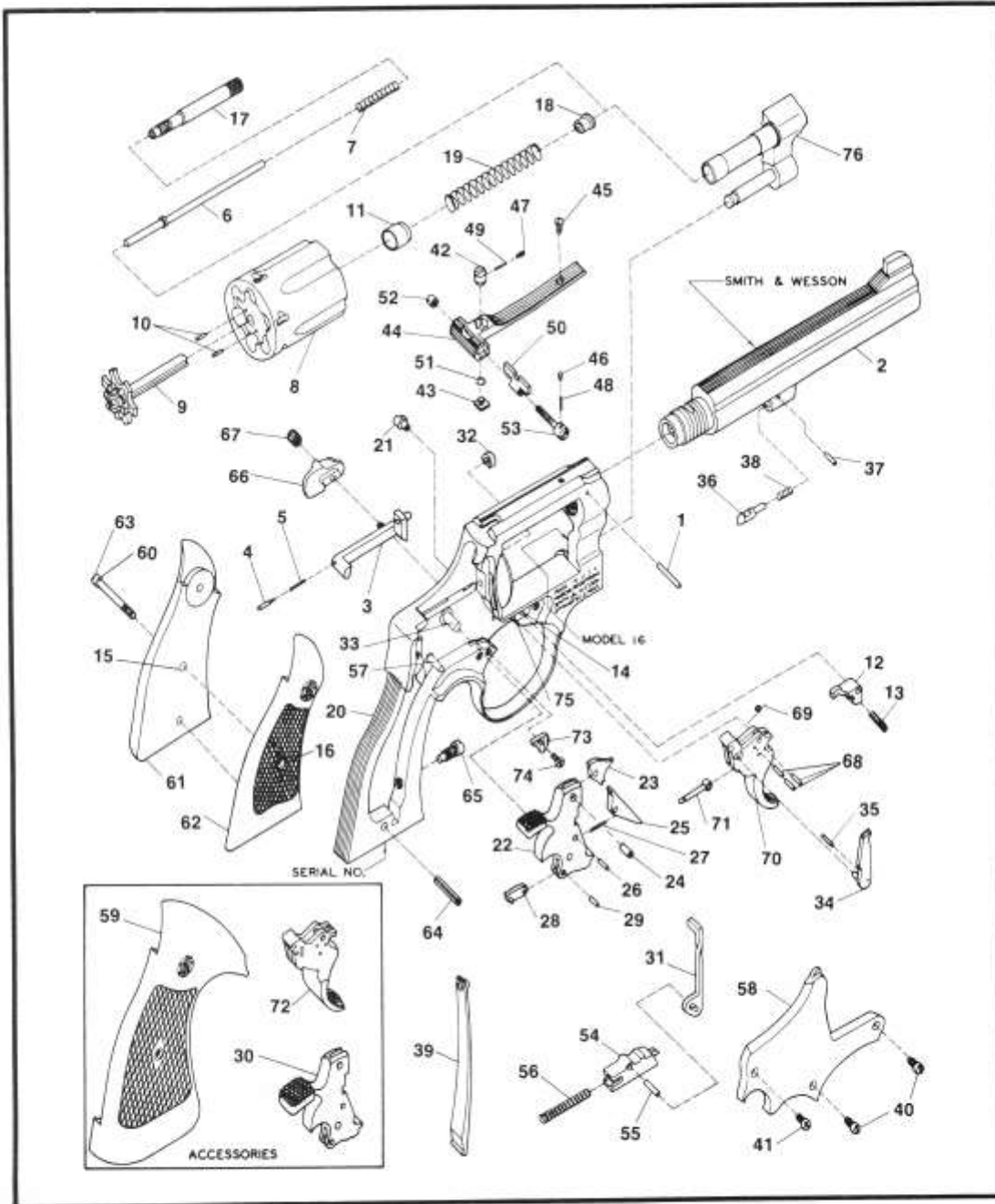

EXPLODED VIEW DIAGRAM.

MODEL 16

**MODEL NO. 16**  
**K FRAME .32 CALIBER REVOLVER**  
**PARTS PRICE SCHEDULE**

View #	Part Number	Part Description	View #	Part Number	Part Description
1	050020000	Barrel Pin .....	53	071880000	Rear Sight Windage Screw .....
2	050990000	Barrel, 6" .....	54-55	041650000	Rebound Slide Assembly .....
3	045770000	Bolt .....			Includes:
4	070980000	Bolt Plunger .....	54	041650000	Rebound Slide (1) .....
5	070200000	Bolt Plunger Spring .....	55	050830000	Rebound Slide Pin .....
6	074720000	Center Pin .....	56	050740000	Rebound Slide Spring .....
7	074640000	Center Pin Spring .....	57	031540000	Rebound Slide Stud .....
8-11	053760000	Cylinder Assembly .....	58	033850000	*Side Plate .....
		Includes:	59	164200000	Stock Assembly, Sq., Tgt. Walnut,
8	053760000	Cylinder (1) .....			Chk. ....
9	054390000	*Extractor Assembly .....	60	072630000	Stock Screw Target .....
10	050140000	Extractor Pin .....	61-67	161070000	Stock Assembly, Square Butt .....
11	045550000	Gas Ring .....			Includes:
12	055570000	Cylinder Stop .....	61	032450000	Stock, Square Butt, Left (1) ...
13	070550000	Cylinder Stop Spring .....	62	032460000	Stock, Square Butt, Right (1) ...
14	031540000	Cylinder Stop Stud .....	63	071910000	Stock, Screw, Square Butt .....
15	040670000	Escutcheon .....	64	050620000	Stock Pin .....
16	040680000	Escutcheon Nut .....	65	050640000	Strain Screw .....
17	054550000	Extractor Rod .....	66	055850000	Thumbpiece .....
18	076850000	Extractor Rod Collar .....	67	050710000	Thumbpiece Nut .....
19	075460000	Extractor Spring .....	68-71	043560000	Trigger Assembly .....
20	054200000	*Frame .....			Includes:
21	032900000	Frame Lug .....	68	070190000	Hand Spring Pin .....
22-29	043550000	Hammer Assembly .....	69	051180000	Hand Torsion Spring .....
		Includes:	68	070190000	Hand Torsion Spring Pin .....
22	050930000	Hammer (1) .....	70	033140000	Trigger (1) .....
23	051330000	Hammer Nose .....	71	070270000	Trigger Lever .....
24	050340000	Hammer Nose Rivet .....	68	070190000	Trigger Lever Pin .....
25	051130000	Sear .....	72	046780000	Trigger Assembly, Target .....
26	070190000	Sear Pin .....			Includes:
27	070200000	Sear Spring .....		031160000	Trigger, Target (1) .....
28	070210000	Scirrup .....	73	074430000	Trigger Stop .....
29	070190000	Scirrup Pin .....	74	030920000	Trigger Stop Screw .....
30	043760000	Hammer Assembly, Target .....	75	050780200	Trigger Stud .....
		Includes:	76	044670000	*Yoke .....
	052120000	Hammer Target (1) .....			
31	050840000	Hammer Block .....			
32	050360000	Hammer Nose Bushing .....			
33	031550000	Hammer Stud .....			
34	077680000	Hand .....			
35	070110000	Hand Pin .....			
36	050430000	Locking Bolt .....			
37	050440000	Locking Bolt Pin .....			
38	050450000	Locking Bolt Spring .....			
39	050470000	Mainspring .....			
40	050490000	Plate Screw, Crowned .....			
41	030910000	Plate Screw, Flat Head .....			
42-53	057870000	Rear Sight Assembly .....			
		Includes:			
42	051020000	Rear Sight Elevation Nut .....			
43	071800000	Rear Sight Elevation Stud .....			
44	057860000	Rear Sight Leaf .....			
45	030920000	Rear Sight Leaf Screw .....			
46	071580000	Rear Sight Plunger .....			
47	071580000	Rear Sight Plunger .....			
48	071590000	Rear Sight Plunger Spring .....			
49	071590000	Rear Sight Plunger Spring .....			
50	051090000	Rear Sight Slide .....			
51	051050000	Rear Sight Spring Clip .....			
52	051070000	Rear Sight Windage Nut .....			

\* Requires factory installation.  
Note (1): Sold as an assembly only.

**SPECIFY MODEL NUMBER, FINISH, PART NUMBER AND PART NAME WHEN ORDERING PARTS.**