

MODEL NO. 649 .38 BODYGUARD STAINLESS REVOLVER

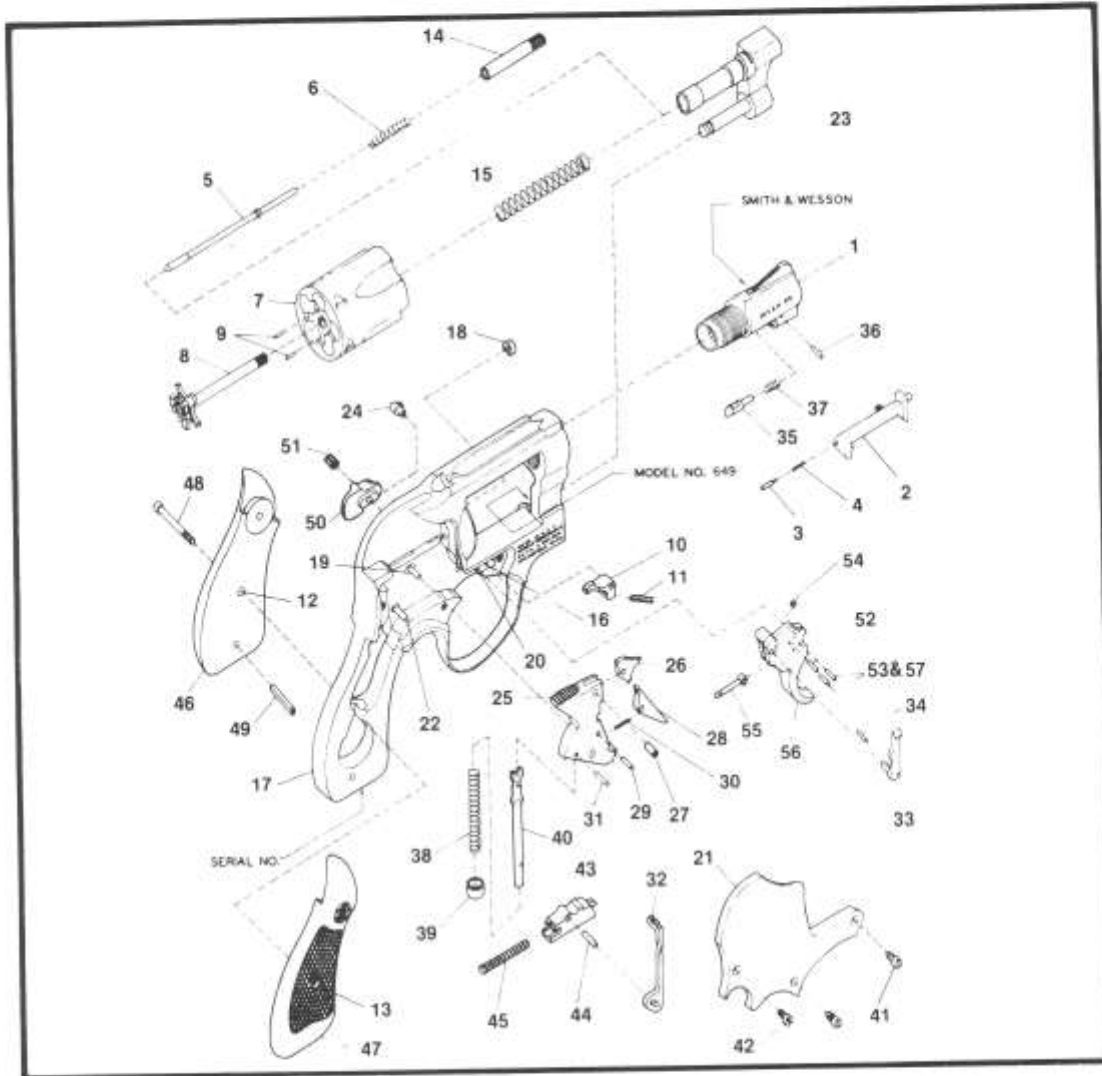

EXPLODED VIEW DIAGRAM.

MODEL 649

MODEL NO. 649 .38 BODYGUARD STAINLESS REVOLVER PARTS PRICE SCHEDULE

<i>View #</i>	<i>Part Number</i>	<i>Part Description</i>	<i>View #</i>	<i>Part Number</i>	<i>Part Description</i>
1	076690000	Barrel 2"	33	070780000	Hand
2	075570000	Bolt	34	070790000	Hand Pin
3	070980000	Bolt Plunger	35	070590000	Locking Bolt
4	070200000	Bolt Plunger Spring	36	070830000	Locking Bolt Pin
5	075690000	Center Pin	37	070140000	Locking Bolt Spring
6	070630000	Center Pin Spring	38	071040000	Mainspring
7-9	077850000	Cylinder Ass'y	39	070610000	Mainspring Swivel
		Includes:	40	070840000	Mainspring Stirrup
7	077850000	Cylinder	41	070850000	Plate Screw, Crowned
8	070650000	Extractor	42	070370000	Plate Screw, Flat
9	072620000	Extractor Pin	43-44	070860000	Rebound Slide Ass'y
10	077750000	Cylinder Stop			Includes:
11	071280000	Cylinder Stop Spring	43	070860000	Rebound Slide
12	040670000	Escutcheon	44	070870000	Rebound Slide Pin
13	040680000	Escutcheon Nut	45	070280000	Rebound Slide Spring
14	070660000	Extractor Rod	46-48	161050000	Stock Ass'y
15	075790000	Extractor Spring			Includes:
16-23	076790000	Frame Ass'y	46	032390000	Stock RD Butt Left
		Includes:	47	032400000	Stock RD Butt Right
16	070700000	Cylinder Stop Stud	48	072550000	Stock Screw
17	076790000	Frame	49	070220000	Stock Pin
18	071240000	Hammer Nose Bush	50	071020100	Thumbpiece
19	070690000	Hammer Stud	51	070250000	Thumbpiece Nut
20	070700000	Trigger Stud	52-57	049350000	Trigger Ass'y .312
21	076800000	Side Plate			Includes:
22	070700000	Rebound Slide Stud	52	070820000	Hand Torsion Spring Pin
23	070890000	Yoke	53	070810000	Hand Spring Pin
24	076660000	Frame Lug	54	070800000	Hand Spring
25-31	076820000	Hammer Ass'y	55	070970000	Trigger Lever
		Includes:	56	031290000	Trigger
25	076810000	Hammer	57	070810000	Trigger Lever Pin
26	071200000	Hammer Nose			
27	071190000	Hammer Nose Rivet			
28	070880000	Sear			
29	070810000	Sear Pin			
30	070200000	Sear Spring			
31	071090000	Stirrup Pin			
32	070760000	Hammer Block			

* Requires factory installation.
Note (1): Sold as an assembly only.
N.I. = Not illustrated.

SPECIFY MODEL NUMBER, FINISH, PART NUMBER AND PART NAME WHEN ORDERING PARTS.